

Pickling Brush specification:-

Nomenclature:-

Spiral brush 320/180-150mm

Specification:-

Outside diameter = 320mm

Inside diameter = 180mm (To be fitted on 180mm dia shaft)

Brush face length = 150mm (Compressed tight wound)

Filament material = Abralon-SC - K500

Filament diameter = 0.50mm

Level:-

Flat / cylindrical

Channel Material:-

SS 304

Wound:-

25 Pieces right hand wound

25 Pieces left hand wound

Application:-

Pickling / washing of copper & copper alloy strip in 10-20% H_2SO_4 solution on continuous pickling line.

Siemens AG, Munich, Germany

4

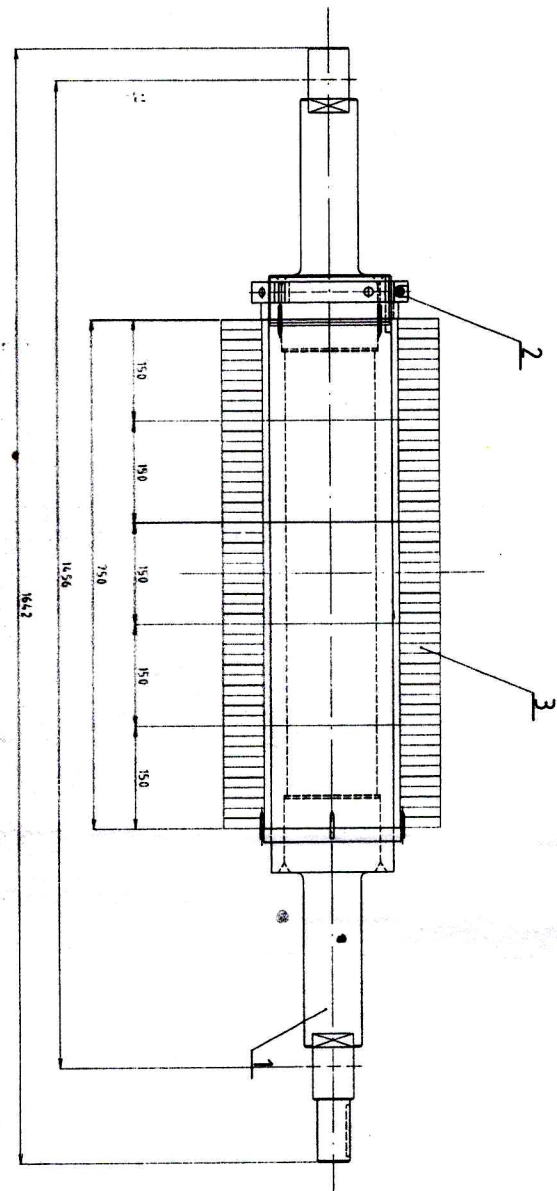
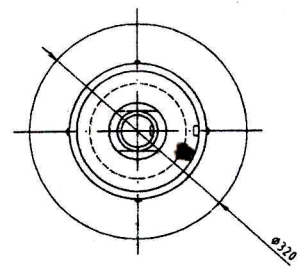

3	BRUSH 320/180 - 150 MAT	Abrasion o 0.50	SK K500	5	10
2	BRUSH HOLDER	14.020-04.18		1	12.8
1	BRUSH CORE	14.020-04.19		1	205.5